

TYPICAL STEEL ROD
DETAIL - ARDEX WPM 8'
SERIES

NOTES

ARDEX PRIMER:

- ARDEX WPM 801 or
- ARDEX WPM 300

Non-porous substrate
preparation: Mechanically abrade
the surface of the metal or PVC
surfaces and remove all loose
debris. Solvent wipe these
surfaces with ARDEX WA 98S and
allow to flash off. Prime prepared
surfaces with ARDEX WPM 801,
and allow to dry between 1 hour –
3 hours. Please ref to the ARDEX
WPM 801 product data sheet for
further information.

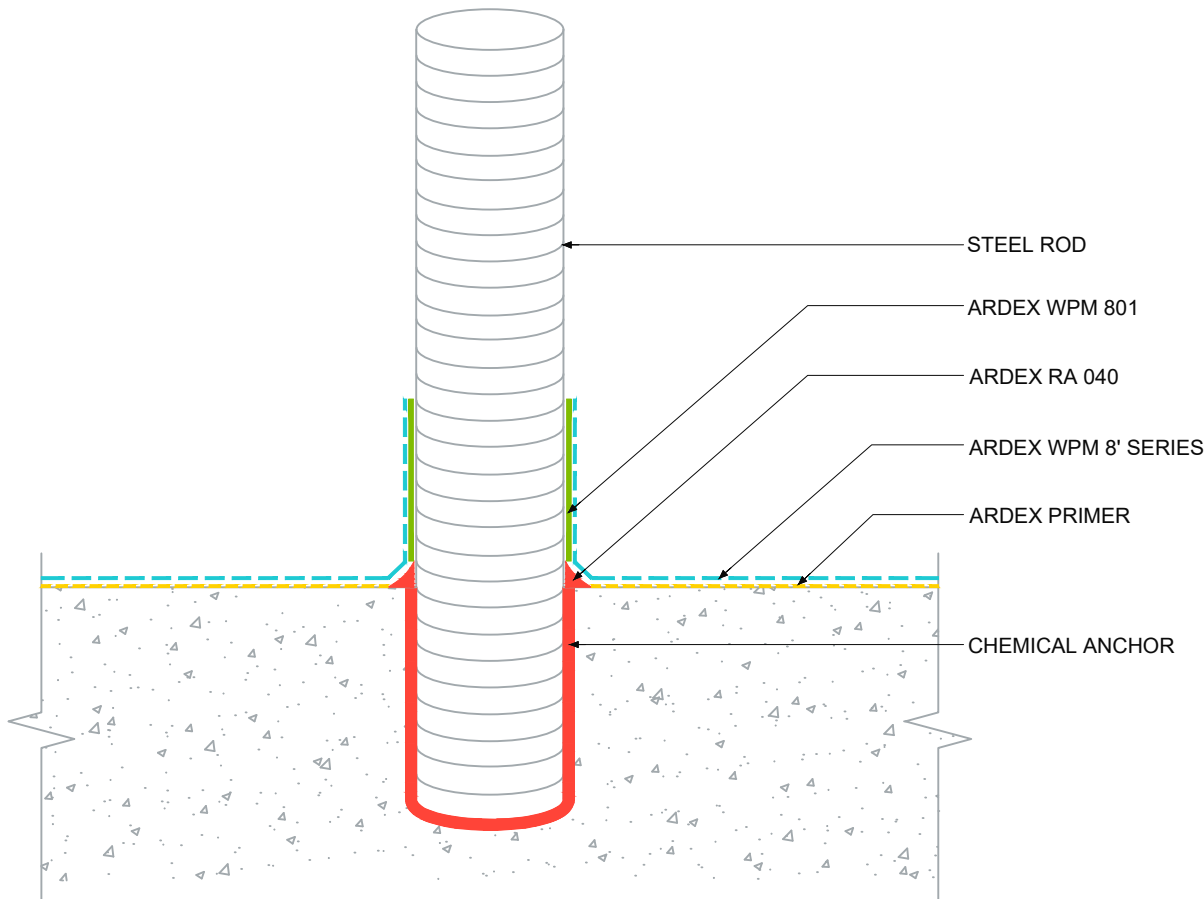

ARDEX AUSTRALIA
www.ardexaustralia.com

The technical details, recommendations & other information contained in this drawing is given in good faith & represents the best of our knowledge and experience at the time of design. It is your responsibility to ensure that our products are used used correctly in accordance with any applicable Australian Standard, our instructions & recommendations are only for the uses they are intended. We also reserve the right to update information without prior notice to reflect our ongoing research and development program. Country specific recommendations, depending on local standards, codes of practice, building regulations and industry guidelines may effect specific installation recommendations. The supply of our products and services are also subject to certain terms, warranties & exclusions which are available to you on request

FILE NAME TYPICAL STEEL ROD DETAIL -
ARDEX WPM 8' SERIES

DRAWN 24/09/2024 by AD

CHECKED ADAM MCGLONE

SIZE A4

SCALE NTS

DRAWING D173