

**BELOW GROUND FOOTING
DETAIL (BLIND CONCRETE
SLAB)**

NOTES

HORIZONTAL INSTALLATION - ARDEX WPM 1500 MEMBRANE CAN BE LOOSE LAID (UNBONDED) ON SUITABLE COMPACTED EARTH OR DIRECTLY BONDED TO PREPARED CONCRETE / BLINDING SLAB

ARDEX WPM 1500 UNBONDED APPLICATION: 100MM (MINIMUM) WELDED LAPS AND SEAMS.

ARDEX WPM 1500 BONDED APPLICATION: 50MM (MINIMUM) WELDED LAPS AND SEAMS.



ARDEX AUSTRALIA
www.ardexaustralia.com

SCALE NTS

DRAWING D36

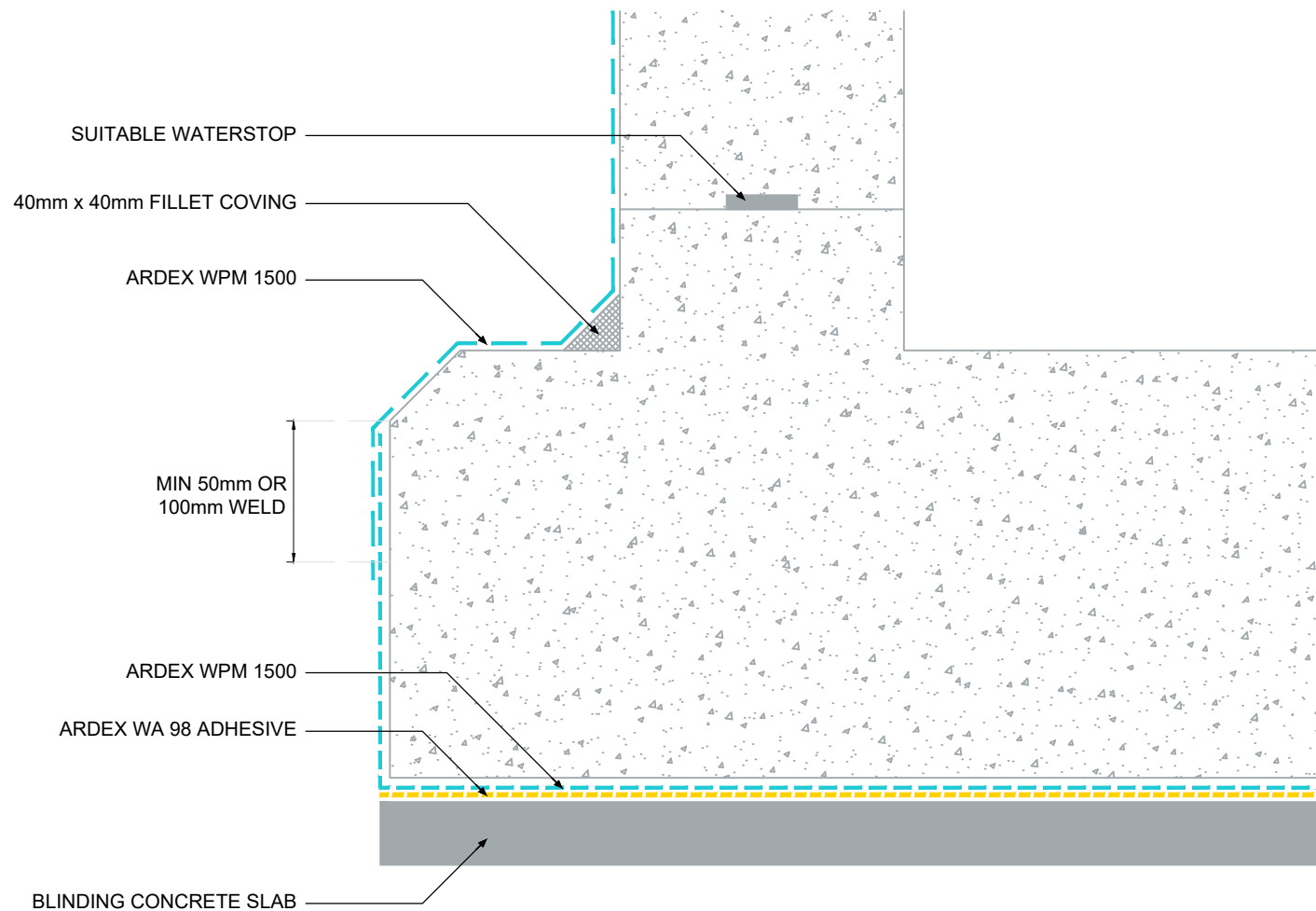

The technical details, recommendations & other information contained in this drawing is given in good faith & represents the best of our knowledge and experience at the time of design. It is your responsibility to ensure that our products are used correctly in accordance with any applicable Australian Standard, our instructions & recommendations are only for the uses they are intended. We also reserve the right to update information without prior notice to reflect our ongoing research and development program. Country specific recommendations, depending on local standards, codes of practice, building regulations and industry guidelines may effect specific installation recommendations. The supply of our products and services are also subject to certain terms, warranties & exclusions which are available to you on request

FILE NAME BELOW GROUND FOOTING DETAIL (BLIND CONCRETE SLAB)

DRAWN AD

CHECKED ADAM MCGLONE

SIZE A4