

TERMINATION AT EXTERNAL DOOR OPENINGS - ARDEX WELDTEC MEMBRANE

NOTES

EXCLUDING ARDEX WPM 750 MEMBRANE
- FOR INTERNAL USE ONLY.

FOR FALLS, SEE AS 4654.2-2012, CLAUSE
2.5.2

1. SUB-SILL IS INSTALLED BEFORE
DOOR
2. SEAL BETWEEN SILL, PACKER AND
MEMBRANE BEFORE DRILLING
FIXING HOLES.

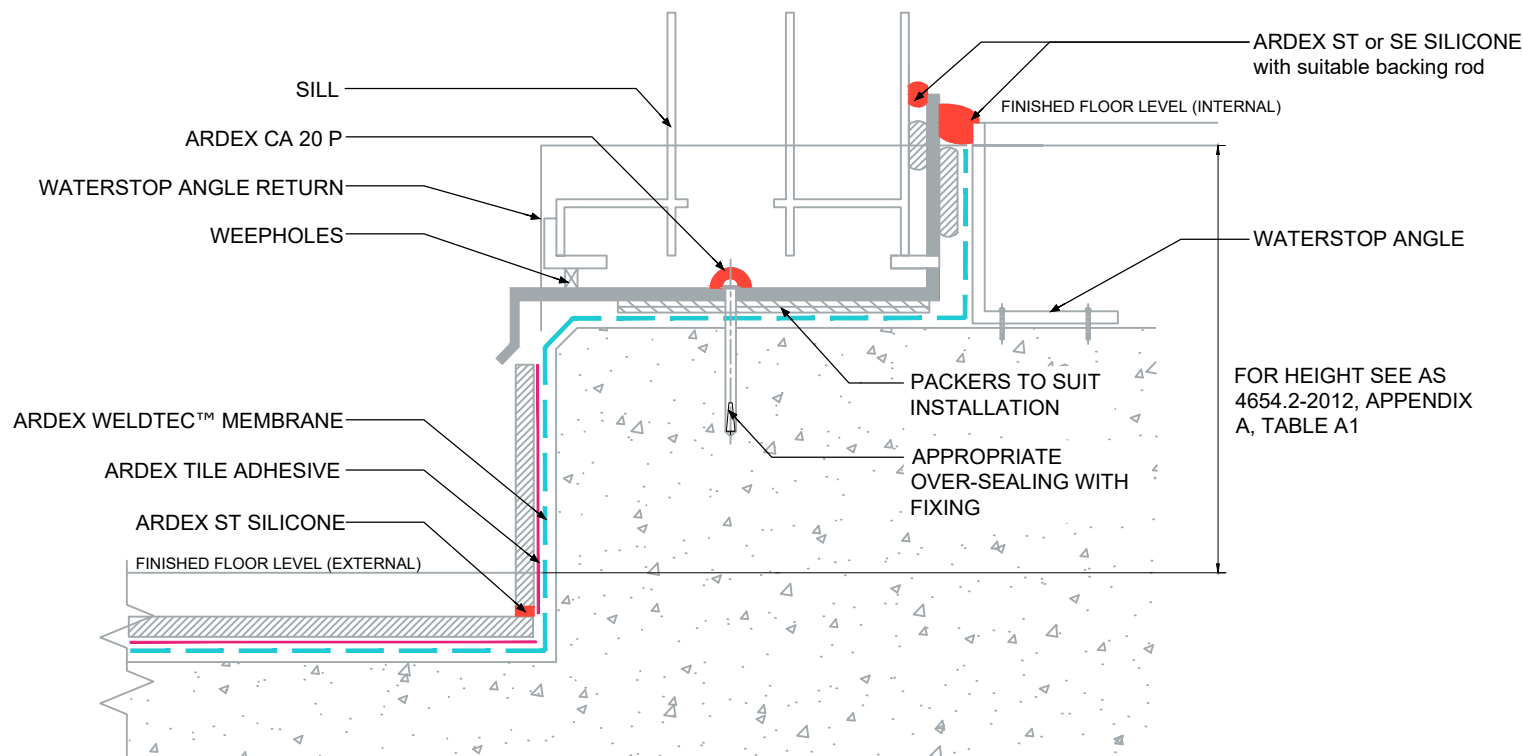

The technical details, recommendations & other information contained in this drawing is given in good faith & represents the best of our knowledge and experience at the time of design. It is your responsibility to ensure that our products are used correctly in accordance with any applicable Australian Standard, our instructions & recommendations are only for the uses they are intended. We also reserve the right to update information without prior notice to reflect our ongoing research and development program. Country specific recommendations, depending on local standards, codes of practice, building regulations and industry guidelines may effect specific installation recommendations. The supply of our products and services are also subject to certain terms, warranties & exclusions which are available to you on request

FILE NAME TERMINATION AT EXTERNAL DOOR OPENINGS
- ARDEX WELDTEC MEMBRANE

DRAWN AD

CHECKED ADAM MCGLONE

SIZE A4

ARDEX AUSTRALIA
www.ardexaustralia.com

SCALE NTS

DRAWING D47