

VERTICAL PIPE PENETRATION WITH ARDEX WELDTEC MEMBRANE (POST APPLIED)

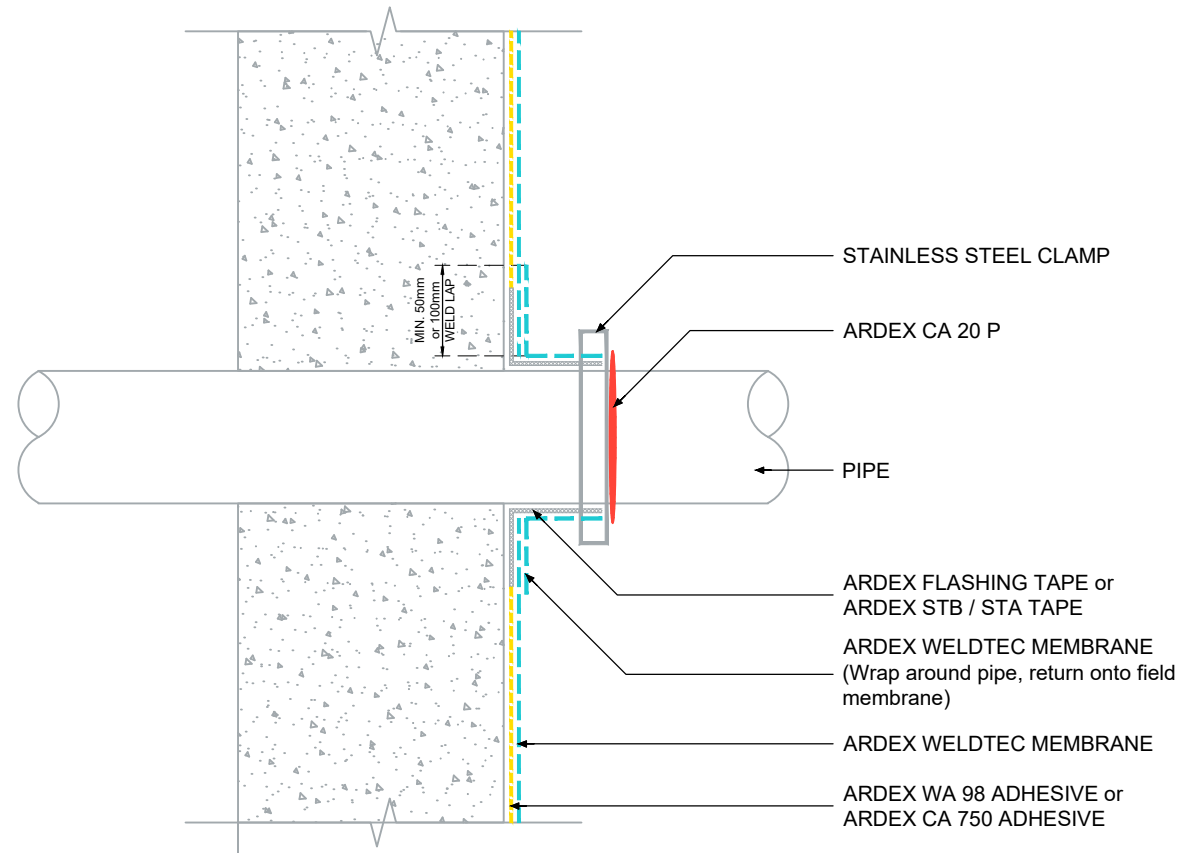

NOTES

ARDEX WPM 1500 welded laps may differ for below ground applications.

UNBONDED APPLICATION: 100mm (MINIMUM) welded laps and seams.

BONDED APPLICATION: 50mm (MINIMUM) welded laps and seams.

ARDEX WA 98 ADHESIVE external application only.

ARDEX CA 750 ADHESIVE internal application only.



ARDEX AUSTRALIA
www.ardexaustralia.com

The technical details, recommendations & other information contained in this drawing is given in good faith & represents the best of our knowledge and experience at the time of design. It is your responsibility to ensure that our products are used correctly in accordance with any applicable Australian Standard, our instructions & recommendations are only for the uses they are intended. We also reserve the right to update information without prior notice to reflect our ongoing research and development program. Country specific recommendations, depending on local standards, codes of practice, building regulations and industry guidelines may effect specific installation recommendations. The supply of our products and services are also subject to certain terms, warranties & exclusions which are available to you on request

FILE NAME	VERTICAL PIPE PENETRATION WITH ARDEX WELDTEC MEMBRANE (POST APPLIED)
DRAWN	22/01/2024 by AR
CHECKED	ADAM MCGLONE
SIZE	A4

SCALE NTS
DRAWING D76